

\\ctafila02\Eng\Projects\2024\24-0055-WS.dwg [C-5] Jul 07, 2025 2:41pm TRUBINO

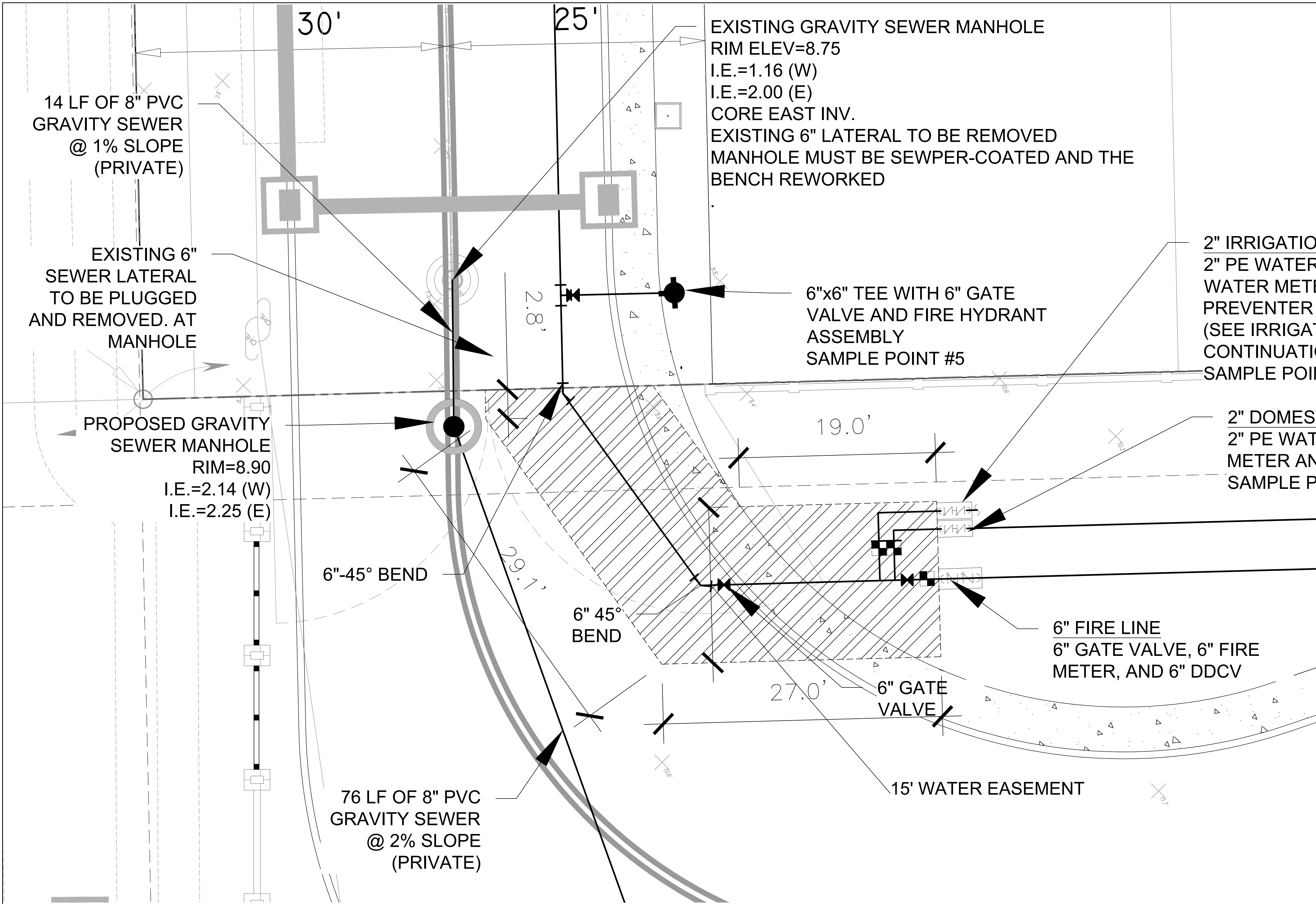

NOTE: ANY EXISTING WATER AND/OR SEWER CONNECTION TO THE SUBJECT LOTS NOT UTILIZED MUST BE CUT AND CAPPED AT THE WATER MAIN IF A WATER SERVICE AND CUT OUT AND SLEEVED IF A SEWER LATERAL. SEWER LATERALS THAT ARE CUT AND CAPPED WILL NEED TO BE AS-BUILT PER THE CITY'S ENGINEERING AS-BUILT STANDARDS.

HOW TO RETIRE OLD LATERALS:

- \* IF THE EXISTING MAIN IS A CLAY PIPE AND HAS A CIPP LINER CURRENTLY INSTALLED, INSTALL A SECTIONAL LINER IN THE MAIN OVER THE OLD LATERAL THUS ELIMINATING THE LATERAL.
- \* IF THE EXISTING MAIN IS CLAY PIPE, DIG DOWN AND CUT OLD CLAY PIPE, SLEEVE BACK IN WITH PVC AND CITY APPROVED COUPLINGS.
- \* IF THE EXISTING MAIN IS CLAY PIPE AND ARE REQUIRED TO RETIRE MULTIPLE LATERALS, IT MAY BE CHEAPER TO INSTALL A CITY APPROVED CIPP LINER FROM MANHOLE TO MANHOLE AND NOT CUT OUT THE LATERALS THAT ARE BEING RETIRED.
- \* IF THE EXISTING MAIN IS PVC PIPE, REMOVE THE LATERAL PIPE FROM THE PVC WYE FITTING AND INSTALL A PLUG INTO THE WYE. INSTALL A GREEN LOCATING MARKING BALL AT THE LATERAL LOCATING, NO DEEPER THAN 4 FEET BELOW GRADE.

PROPOSED LEGEND:

- |  |                                     |  |                                    |
|--|-------------------------------------|--|------------------------------------|
|  | FIRE HYDRANT ASSEMBLY               |  | RIM ELEVATION                      |
|  | GATE VALVE                          |  | INVERT ELEVATION                   |
|  | WATER METER                         |  | SANITARY SEWER MANHOLE             |
|  | CORPORATION STOP                    |  | CLEANOUT                           |
|  | REDUCER                             |  | SANITARY SEWER PIPE FLOW DIRECTION |
|  | BACKFLOW PREVENTER                  |  | SANITARY (SINGLE) SERVICE          |
|  | SIAMESE FIRE CONNECTION             |  | SANITARY (DOUBLE) SERVICE          |
|  | PLUG                                |  | WATER AND SEWER EASEMENT           |
|  | VERTICAL DDCV                       |  | PAVEMENT RESTORATION               |
|  | VERTICAL MOUNTED BACKFLOW PREVENTER |  |                                    |
|  | CONFLICT CALLOUT                    |  |                                    |
- BOT. = X.XX  
TOP = X.XX

WATER AND SEWER CONSUMPTION

Truck Wash:  
300 gallons total per wash with 75% of the water being recycled  
75 gallons of water and sewer per wash  
150 Trucks serviced daily  
Estimated water and sewer usage = 75 gallons per wash x 150 washes per day = 11,250 GPD

Office:  
2,214 SF Office Building  
2,214 x 0.212 = 0.469 ERU  
0.469 ERU x 257 GPD = 120 GPD

TOTAL ESTIMATED WATER AND SEWER CONSUMPTION = 11,370 GPD

Broward County Water and Wastewater Engineering Division  
was utilized for the ERU factor schedule.  
1 ERU per 257 GPD  
Building: 1,000 SF = 0.212 ERU

WATER AND SEWER NOTES:

- CONTRACTOR SHALL FIELD VERIFY LOCATION, DEPTH, AND SIZE OF ALL EXISTING UTILITIES VIA SOFT DIG PRIOR TO COMMENCEMENT OF INSTALLATION OF THE WATER, SEWER, AND FIRE SERVICES FOR THE SITE. CONTRACTOR SHALL SOFT DIG AT EVERY CROSSING LOCATION.
- ALL WATER MAIN PIPES 4" AND LARGER SHALL BE CLASS 52 MECHANICAL JOINT AND CEMENT MORTAR LINED. ALL D.I.P. SHALL BE POLY WRAPPED IN ACCORDANCE WITH C105/A21.5-05.
- ALL WATER MAIN PIPE, INCLUDING FITTINGS, SHALL BE COLOR CODED OR MARKED BLUE AS A PREDOMINANT COLOR TO DIFFERENTIATE DRINKING WATER FROM RECLAIMED OR OTHER WATER. ALL FITTINGS AND PIPING FLANGED BOLTS, NUTS, AND WASHERS SHALL BE MADE OF A-316 STAINLESS STEEL.
- ALL PROPOSED BACKFLOW DEVICES SHALL BE LEAD FREE.
- THE BACKFLOW PREVENTERS/DDCV ARE LOCATED AT OR BEHIND THE FACADE LINE OR THE BUILDING ON THE APPROVED PLANS AND MUST BE LOCATED AT OR BEHIND THE FRONT OF THE BUILDING ON THE APPROVED PERMITS PLANS, AND CANNOT BE LOCATED IN FRONT OF THE BUILDING.
- ANY EXISTING UNUTILIZED WATER AND/OR SEWER CONNECTION MUST BE CUT AND CAPPED/PLUGGED AT THE MAIN.
- ALL PROPOSED FIRE LINES, I.E., MAINS, FIRE SERVICES, "SIAMESE" CONNECTION LINES ETC. TO BE DESIGNED, PERMITTED, & INSTALLED BY A STATE LICENSED FIRE LINE CONTRACTOR PER F.S. 633.
- ALL FIRE LINES TO BE INSPECTED BY CERTIFIED FIRE LINE INSPECTORS.
- STATE LICENSED FIRE LINE CONTRACTOR, UPON COMPLETION OF REQUIRED TESTING, SHALL ISSUE A "LICENSED UNDERGROUND TEST CERTIFICATE" PRIOR TO ACCEPTANCE FOR PLACING FIRE LINE INTO SERVICE.
- ANY EXISTING WATER SERVICE CONNECTION TO THE SUBJECT LOTS NOT UTILIZED MUST BE CUT AND CAPPED AT THE WATER MAIN.
- ANY EXISTING SEWER LATERAL SERVING THE SUBJECT LOTS NOT UTILIZED MUST BE CUT OUT AND SLEEVED.
- FIRE DEPARTMENT CONNECTION MUST REMAIN CLEAR AND ACCESSIBLE. MINIMUM 3 FEET EACH SIDE AND REAR WITH A MINIMUM 6 FEET CLEAR WIDTH IN FRONT OUT TO ROADWAY FOR FIRE APPARATUS ACCESS.
- UNDERGROUND UTILITY LINES SHALL BE ROUTED AROUND THE TREE PROTECTION AREA WHERE POSSIBLE. IF THIS IS NOT POSSIBLE, A TUNNEL MADE BY A POWER-DRIVEN SOIL AUGER MAY BE USED UNDER THE TREE (AS PER 155.5204.F.3.D).

THE WATER AND SEWER PROVIDER FOR THE PROJECT IS THE CITY OF POMPAÑO BEACH.

VERTICAL INFORMATION HEREON IS RELATIVE TO THE NORTH AMERICAN VERTICAL DATUM (NAVD88). [NAVD88 = NGVD29 - 1.59']

This document has been digitally signed and sealed by Chad Everett Edwards, P.E. on the date indicated here. Printed copies of this document are not considered signed and sealed and the signature must be verified on any electronic copies.

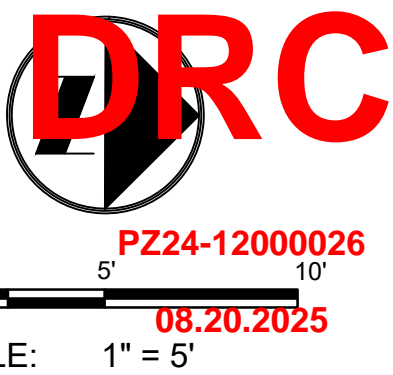

1501 WEST ATLANTIC BLVD.  
POMPAÑO BEACH, FLORIDA  
PREPARED FOR:  
KAJA PROPERTIES INC.  
WATER & SEWER PLAN

CRAVEN - THOMPSON AND ASSOCIATES, INC.  
ENGINEERS • PLANNERS • SURVEYORS  
3563 N.W. 53RD STREET, FORT LAUDERDALE, FLORIDA 33309  
FAX: (954) 739-6409 TEL: (954) 739-6400  
FLORIDA LICENSED ENGINEERS, SURVEYORS & MAPPING BUSINESS NO. 271  
FLORIDA LICENSED LANDSCAPE ARCHITECTURE BUSINESS NO. C00014  
MATERIAL SHOWN HEREON IS THE PROPERTY OF CRAVEN THOMPSON & ASSOCIATES, INC. AND SHALL NOT BE REPRODUCED OR IN PART WITHOUT WRITTEN PERMISSION OF CRAVEN THOMPSON & ASSOCIATES, INC. COPYRIGHT © 2015

CHAD E. EDWARDS, P.E.  
FLORIDA LICENSE No. 59306  
2025-07-07

PROJECT NO.  
24-0055-001-01

C-5  
SHEET 5 OF 14